

# CAREL



refrigeration and retail controllers  
refrigeration controllers



**55%**  
energy savings

easy clock & easy door

“energy saving” electronic controllers  
for Bottle Coolers, Open Front Cabinets  
& Vending Machines

[carel.com](http://carel.com)

# easy clock & door - CAREL electronic controllers with "energy saving" function

The "energy saving" function ensures significant energy savings as it adapts to store opening times.

The experience acquired over recent years in these market niches has led to the proposal of the best possible solutions, offering two different possibilities in terms of price and performance.

- easy "clock" uses an internal clock to set the exact store opening and closing times;
- easy "door" detects when the door is opened and automatically adapts to sales movements. It can also be used on Open Front cabinets;

Energy is saved by optimising unit management, distinguishing between daytime and night-time operation. At night the lights can be switched off and the control set point increased without this affecting refrigerated product quality.

Consequently, energy consumption is reduced in periods when the store is not open to the public.

This means the shopkeeper or store manager doesn't need to unplug the units in the evening and, at the same time, eliminates the problem of peaks in consumption when the store opens again the next morning.

easy clock and easy door completely manage the compressor, inside light and evaporator fan, meaning cooling capacity can be exploited to the maximum and the temperature stabilised.

The display is available in red and green.

The special resin coating protects the electronic circuit against moisture and dust.



**55%**  
energy savings



## Easy to clean

Thanks to the perfectly flat keypad and IP65 protection at the front.



## Easy to read

High efficiency display and digits that are 27 % larger compared to a traditional display



## Easy to plug

Wiring is made simple by the built-in transformer and the power relays with ratings until 2 HP.

## easy clock:

comes with an internal clock (Real Time Clock) used to adjust the set point and light operation based on set time bands

The time bands mean operation of the showcase precisely reflects store opening times:

- Independent time bands for the set point and the light, allowing set point and light operation in sync or at different times;
- Defrosts and automatic day/night switching can be disabled during the IPD stage (Initial Pull Down)

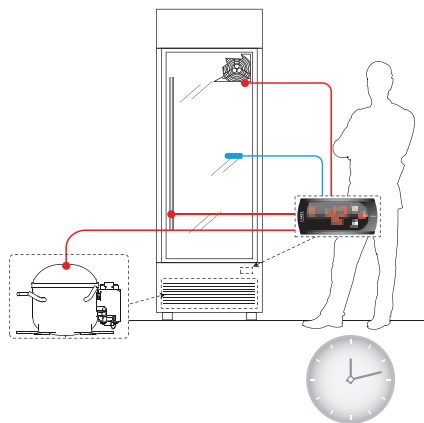

## easy door:

automatically adapts to the opening times by detecting when the cabinet door is open

When, during the day, the door is not opened for a certain set number of hours, the controller automatically switches to night mode:

- switching between night/day status also corresponds to closing/opening the night blind on the front of Open Front cabinets;
- special function for identifying any refrigerant leaks

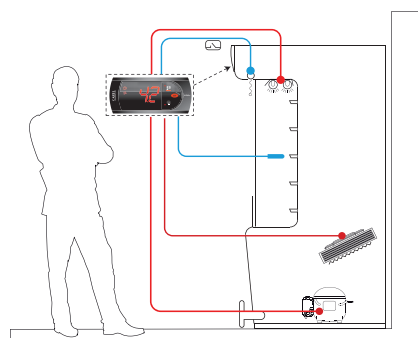
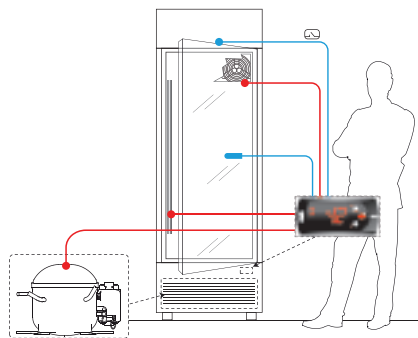

## Dimensions in mm

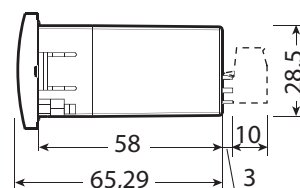
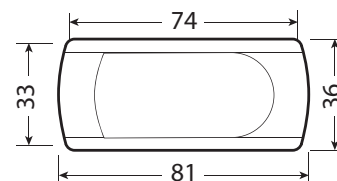

## Wiring diagrams

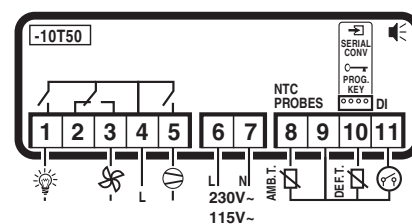

### Easy light

The light can be switched on or off at any time.



### Energy saving

The "ES" button can be used to activate/deactivate the energy saving function, independently of the automatic procedures



### Easy clock

Ensures operation that perfectly reflects store opening times

# Technical specifications

Description	easy clock		easy door		
	Code	PJS3C0M000	PJS3C0MG00	PJS4C0H000	PJS4C0HG00
Display	Red	Green	Red	Green	Red
Power supply	230V				115V NEW!
Energy Saving activation mode	<ul style="list-style-type: none"> <li>Automatic activation: with Real Time Clock according to set time bands.</li> <li>Manual activation: with special "ES" button.</li> </ul>		<ul style="list-style-type: none"> <li>Automatic activation: with auto-adaptation based on door sensor status.</li> <li>Manual activation: with special "ES" button, including when installed inside the cabinet.</li> </ul>		
Inputs	<ul style="list-style-type: none"> <li>Control probe</li> <li>Optional:                             <ul style="list-style-type: none"> <li>- evaporator probe</li> <li>- condenser probe</li> </ul> </li> </ul>		<ul style="list-style-type: none"> <li>Control probe</li> <li>Digital input for door sensor</li> <li>Optional:                             <ul style="list-style-type: none"> <li>- evaporator probe</li> </ul> </li> </ul>		
Relays	Compressor 2HP Fan 8 A Light 8 A		Compressor 2HP Fan 8 A Light 8 A Using the VPM software, the fan relay can be configured as a defrost relay		
Certification	CE & UL				

## Headquarters ITALY

**CAREL INDUSTRIES HQs**  
Via dell'Industria, 11  
35020 Brugine - Padova (Italy)  
Tel. (+39) 0499 716611  
Fax (+39) 0499 716600  
carel@carel.com

## Sales organization

CAREL Asia  
[www.carel.com](http://www.carel.com)

CAREL Australia  
[www.carel.com.au](http://www.carel.com.au)

CAREL China  
[www.carel-china.com](http://www.carel-china.com)

CAREL South Africa  
[www.carelcontrols.co.za](http://www.carelcontrols.co.za)

CAREL Deutschland  
[www.carel.de](http://www.carel.de)

CAREL France  
[www.carelfrence.fr](http://www.carelfrence.fr)

CAREL Iberica  
[www.carel.es](http://www.carel.es)

CAREL HVAC/R Korea  
[www.carel.com](http://www.carel.com)

CAREL Russia  
[www.carelrussia.com](http://www.carelrussia.com)

CAREL India  
[www.carel.in](http://www.carel.in)

CAREL Sud America  
[www.carel.com.br](http://www.carel.com.br)

CAREL U.K.  
[www.careluuk.co.uk](http://www.careluuk.co.uk)

CAREL U.S.A.  
[www.carelnusa.com](http://www.carelnusa.com)

## Affiliates

CAREL Czech & Slovakia  
[www.carel-cz.cz](http://www.carel-cz.cz)

CAREL Korea (for retail market)  
[www.carel.co.kr](http://www.carel.co.kr)

CAREL Ireland  
[www.carel.com](http://www.carel.com)

CAREL Thailand  
[www.carel.co.th](http://www.carel.co.th)

CAREL Turkey  
[www.carel.com.tr](http://www.carel.com.tr)